

ACCESSORY SPECIFICATIONS

1. PRODUCT NAME

Rigid Vinyl
Drywall & Veneer
Accessories
Rigid Vinyl also known as PVC
(Unplasticized Chloride)

2. MANUFACTURER

VINYL CORP.™
8000 N.W. 79th Place
Miami, Florida 33166
Phone: 305/477-6464
Fax: 305/477-4108
National Watts:
800/648-4695

3. PRODUCT DESCRIPTION

Drywall & Veneer accessories are manufactured by Vinyl Corp.™, using lead-free, virgin vinyl compounds, formulated to have durability and toughness.

Drywall & Veneer Accessories: Corner Beads, Arch Beads, Bullnose Beads, Bullnose Arch Beads, J-beads, Bullnose J-Beads, Stop Beads, Adjustable Corner Trim, Reveals, L-Beads, Channel Reveal Intersections, "F" Channel Reveals, Partition End Caps, Control Joints, "F" Control Joints, Soffit Vents, and other miscellaneous vinyl accessories.

Durability: They are impervious to corrosion when coated with veneer plaster, wet joint compounds or when placed in contact with steel or aluminum frames. Vinyl accessories do not contain plasticizers which could migrate to the surface.

Impact Resistance: Due to superior impact resistance, rigid vinyl accessories are resistant to dents and kinks of corners and edges, during construction.

Corrosion Resistance: Vinyl accessories are impervious to rust, corrosion, galvanic corrosion, electrolysis, and are not affected by fast setting joint compounds or topping compounds.

Solid Color: Standard color is white

Paint Adhesion Properties: Excellent, no priming is required.

Ignition Resistance: Rigid vinyl is self extinguishing, and will not continue to support combustion once flame source is removed, therefore it will not cause a fire to re-start or spread. It offers better resistance to burning than many other common building materials.

Electrical Conductivity: Rigid vinyl possesses low electrical conductivity.

Thermal Conductivity: Rigid vinyl is warm to the touch and has a very low transmission of heat or cold, and it is considered an excellent insulator.

Expansion and Contraction: Vinyl Corp.™ wall & ceiling accessories are manufactured, when needed, with perforations in the flanges to allow finishing compounds or veneer plaster to flow thru and bond to wallboard. Perforated flanges remain embedded in matrix to reinforce the edges and corners. These factors, along with the fastening of accessories to substrate prior to coating, makes the accessories part of the building unit and therefore will move with it as the temperature changes. Consequently the coefficient of expansion of rigid vinyl has little or no bearing on the installation.

Basic Uses: To produce durable, straight edges, corners, smooth curvatures, arches and soffit ventilation. To protect and preserve edges of wallboard from impact and condensation.

4. TECHNICAL DATA

Applicable Standards:

ASTM C1047

ASTM D3678 Class 2

Limitations: Not recommended for exterior applications unless noted by exterior ASTM specification number.

5. INSTALLATION

Applicable Standards:

Installation shall be in accordance with ASTM standards and prevalent industry standards and good practices. Vinyl accessories shall be mechanically fastened to substrate in straight lines or smooth curves.

6. AVAILABILITY AND COSTS

Vinyl Corp.™ accessories are generally priced lower than equivalent products manufactured in galvanized steel and substantially lower than zinc or aluminum. Vinyl Corp.™ accessories are in stock and will usually be shipped within 24 hours after receipt of order. Accessories are marketed nationwide thru distributors and building supply dealers.

7. PACKAGING

275 lb. test, double wall, corrugated boxes.

8. WARRANTY INFORMATION

Available upon request.

Note: All size references are nominal dimensions and subject to normal manufacturing tolerances. All product lengths are 10' unless otherwise noted.

MATERIAL DATA

MINIMUM PROPERTIES	ASTM	@0°F	@32°F	@72°F
Tensile Strength, psi	D-638			6,500
Tensile Modulus, psi	D-638			335,000
Flexural Strength, psi	D-790			10,900
Flexural Modulus, psi	D-790			382,000
Izod Impact(ft.-lbs./in.)	D-256			2
MISCELLANEOUS MINIMUM PROPERTIES			ASTM	@72°F
Heat Distortion Temperature (°F @ 264 psi)			D-648	167
Coefficient of Linear Thermal Expansion (in./in. °F x 10 ⁻⁵)			D-696	3.60
Durometer "D" Hardness				83
Specific Gravity				1.47

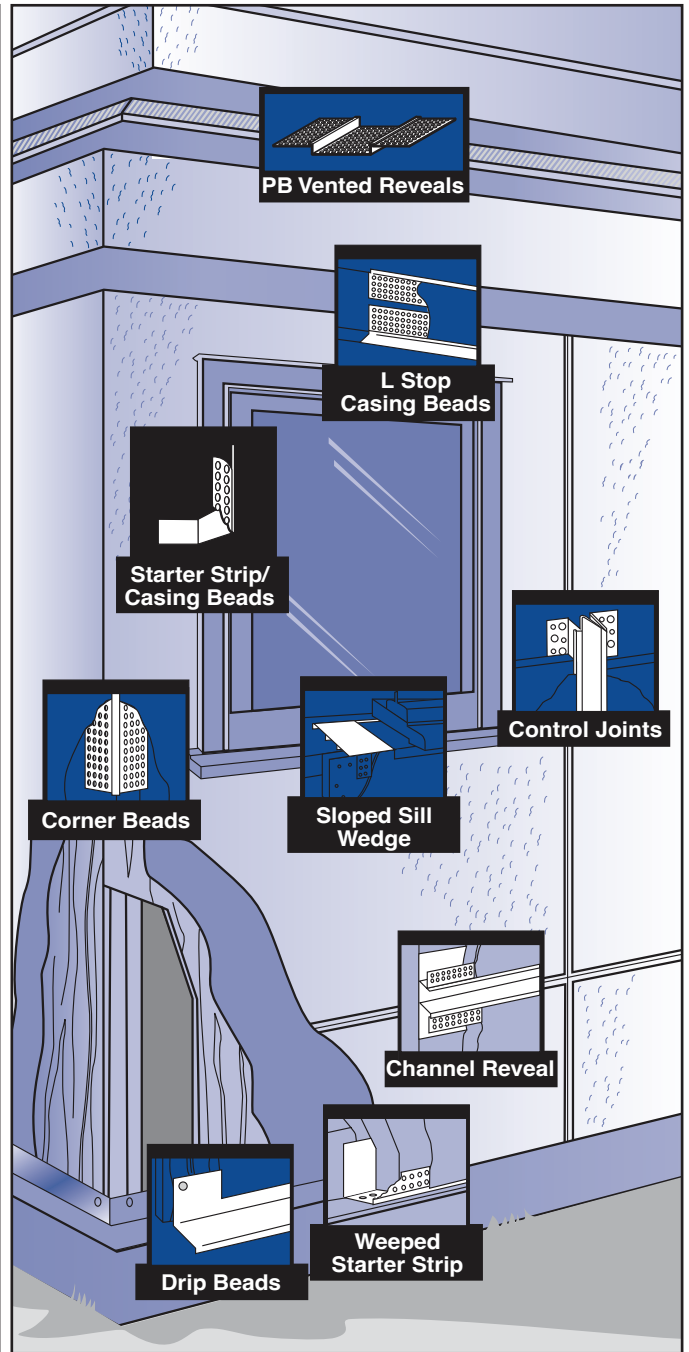
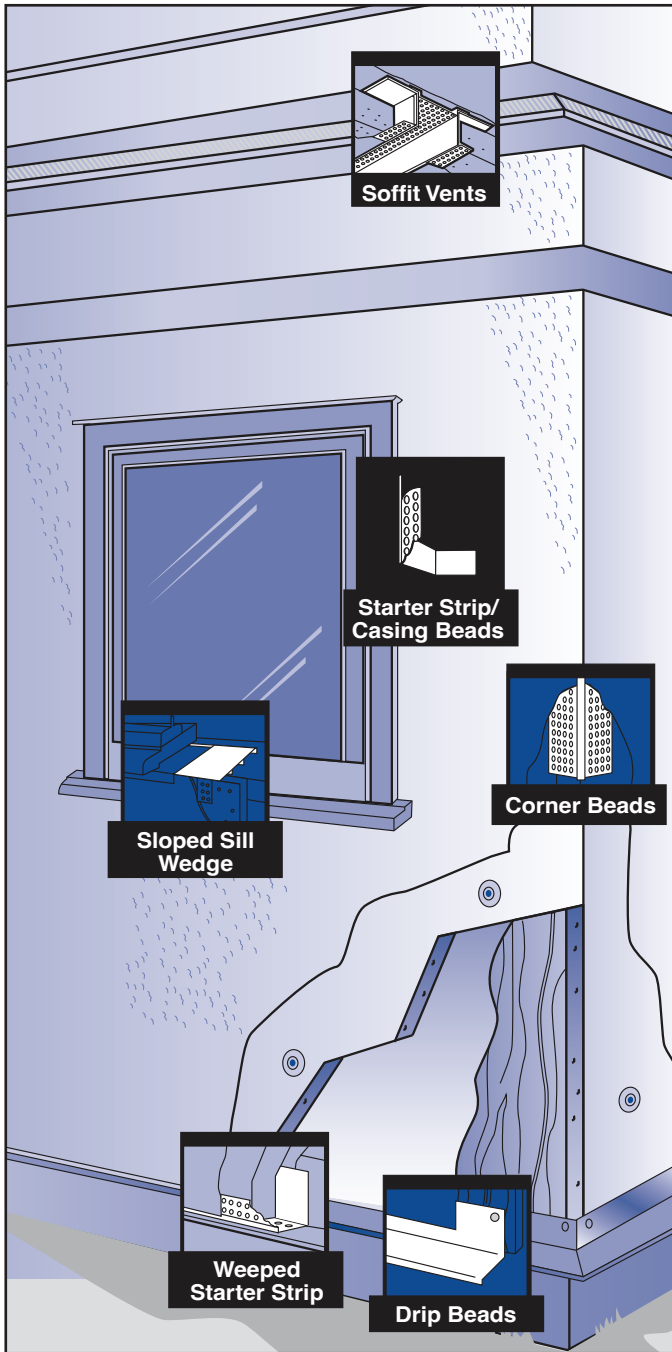

PB Foundation Weep Screeds

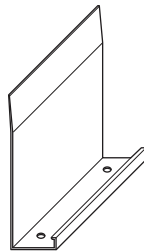
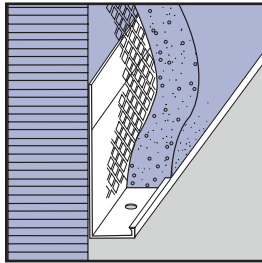

PRODUCT NUMBER	FINISH THICKNESS	DIMENSIONS	PIECES PER BOX
FWS6678W	7/8"	3-1/2" overall width, unperforated flange height	40

Foundation Weep Screeds – Acts as a stop, and has been designed with an unperforated flange to allow moisture removal from EIFS PB installations on frame construction at the foundation line.

Caulk all intersections, butt joints, ends and corners at time of installation.

PB Starter Strip/Casing Beads

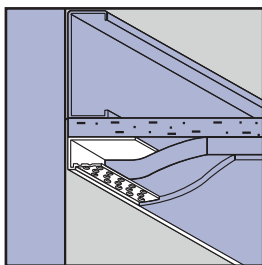

1/16" Finish

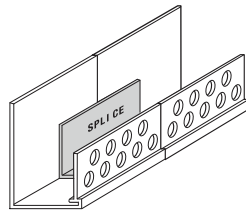

PRODUCT NUMBER	FINISH THICKNESS	INSULATION THICKNESS	DIMENSIONS	PIECES PER BOX
CBS100-16	1/16"	1"	1-3/4" back flange, 5/8" perforated flange	45
CBS150-16	1/16"	1-1/2"		30
CBS200-16	1/16"	2"		20
CBS250-16	1/16"	2-1/2"		20
CBS300-16	1/16"	3"		16

EIFS PB Standard Starter Strip/Casing Beads – Designed by Vinyl Corp.™ as a base support Starter Strip or perimeter Casing Bead for 1/16" exterior insulated wall and ceiling systems. Perforated flange allows matrix to easily flow thru and anchor to substrate. All have the Vinyl Corp.™ "Keylock"™ Splice for connecting multiple sections and alignment.

Caulk all intersections, butt joints, ends and corners at time of installation.

PB Starter Strip/Casing Beads

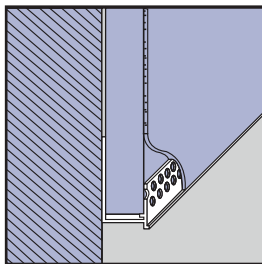

(with Drip and Weep) 1/16" Finish

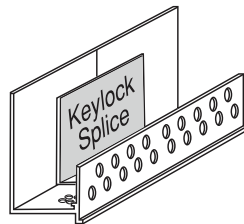

PRODUCT NUMBER	FINISH THICKNESS	INSULATION THICKNESS	DIMENSIONS	PIECES PER BOX
CBS100-16DW	1/16"	1"	2" back flange, 5/8" perforated flange	40
CBS150-16DWF	1/16"	1-1/2"		30
CBS200-16DWF	1/16"	2"		20
CBS250-16DWF	1/16"	2-1/2"		20
CBS300-16DWF	1/16"	3"		16

EIFS PB Starter Strip/Casing Beads (With Drip and Weep) – Designed by Vinyl Corp.™ as a base support Starter Strip with drip leg and weep holes for 1/16" exterior insulated wall and ceiling finish systems. Perforated flange allows matrix to easily flow thru and anchor to substrate. Drip leg moves moisture away from openings or foundation wall. Casings are available standard (W) and with weep holes in front (WF). All have the Vinyl Corp.™ "Keylock"™ Splice for connecting multiple sections and alignment. **Starter Strip/Casing Bead U.S. Patent Numbers 5,946,870 and 6,119,429.**

Caulk all intersections, butt joints, ends and corners at time of installation.

PB Header Weeped Starter Strip

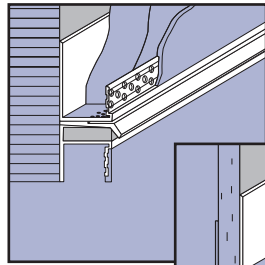

(with Drip) 3/32" Finish

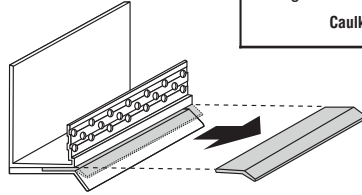
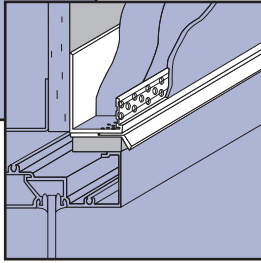

PRODUCT NUMBER	FINISH THICKNESS	INSULATION THICKNESS	DIMENSIONS	PIECES PER BOX
DCBS150-332	3/32"	1-1/2"	2-1/2" back flange, perforated flange	10
DCBS200-332	3/32"	2"		10
DCBS250-332	3/32"	2-1/2"		10

Weeped Starter Strip (With Drip) – Heavy-duty base support starter strip or perimeter casing bead for 3/32" exterior insulated wall and ceiling finish systems. Designed with front weep holes and drip leg to move moisture away from opening headers. Supplied with a disposable protective strip to prevent clogging during matrix application. **U.S. Patent Numbers 5,970,671 and 6,134,847.**

Caulk all intersections, butt joints, ends and corners at time of installation.

DEFS 45 Degree L Bead

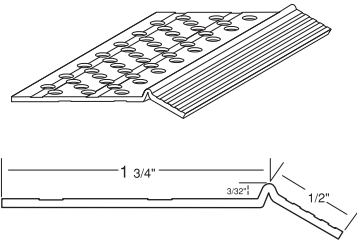
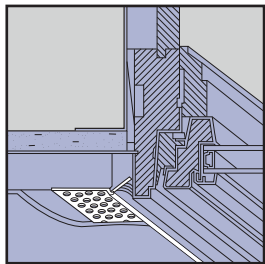

PRODUCT NUMBER	DIMENSIONS	PIECES PER BOX
DE/LB-45	perforated flange	50

45 Degree L Bead – Trim component used to finish around window and door penetrations as a backing for perimeter sealant application in DEFS installations.

Caulk all intersections, butt joints, ends and corners at time of installation.

PB Channel Reveals

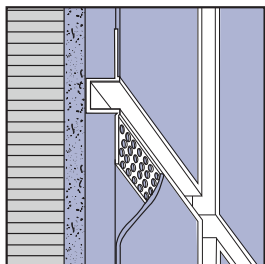

(Surface Mount – 1/16" to 3/32" Finish Systems)

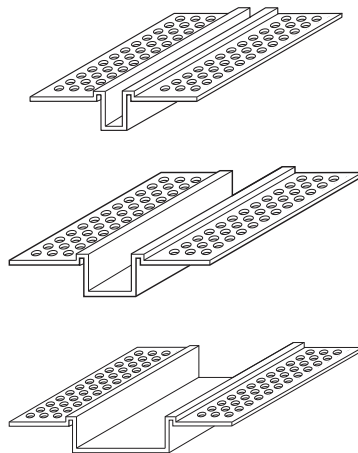

PRODUCT NUMBER	GROUND	DIMENSIONS	PIECES PER BOX
DC50-50SE	1/2"	1/2" reveal, perforated flanges	35
DC50-75SE	1/2"	3/4" reveal, perforated flanges	30
DC50-100SE	1/2"	1" reveal, perforated flanges	30
DC50-150SE	1/2"	1-1/2" reveal, perforated flanges	25
DC50-200SE	1/2"	2" reveal, perforated flanges	25

Channel Reveals (1/16" to 3/32" Finish Systems) – Creates reveals in exterior wall systems. Perforations allow matrix to easily flow thru and adhere to substrate. Factory-fabricated intersections are available to form clear channels.

Caulk all intersections, butt joints, ends and corners at time of installation.

Bold listing signifies new product offering.

PB Vented Reveals

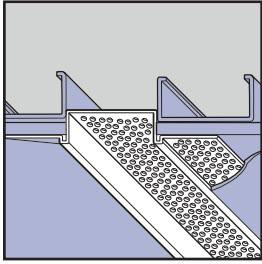

(Surface Mount — 1/16" to 3/32" Systems)

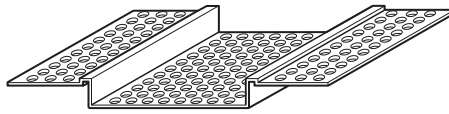

PRODUCT NUMBER	GROUND	DIMENSIONS	PIECES PER BOX
DCV50-150SE	1/2"	1-1/2" reveal	25
DCV50-200SE	1/2"	2" reveal	25
DCV50-300SE	1/2"	3" reveal	20

PB Vented Reveal – Creates a Vented reveal in exterior wall systems. Perforated flanges allow matrix to easily flow thru and adhere to substrate. **Vent Area:** 1-1/2" – 6 square inches per lineal ft.; 2" – 8 square inches per lineal ft.; 3" – 15 square inches per lineal ft.

Caulk all intersections, butt joints, ends and corners at time of installation.

PM Casing Beads

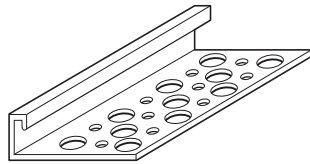
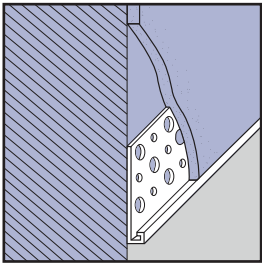

PRODUCT NUMBER	FINISH THICKNESS	INSULATION THICKNESS	DIMENSIONS	PIECES PER BOX
6625	1/4"	ALL	1-3/4" flange width, perforated flanges	100

PM Surface Casing Beads – Designed by Vinyl Corp.™ as a surface-mounted, direct applied base support Starter Strip or perimeter Casing Bead for 1/4" or 3/8" exterior insulated wall and ceiling systems. Perforated flange allows matrix to easily flow thru and anchor to substrate. *Note: 6638 also available with weep holes, order code 6638W. No return leg on 66187.*

PM Control Joints

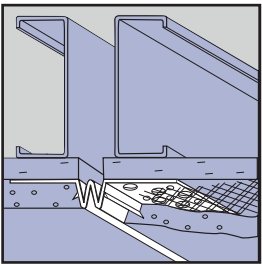

3/8" Finish Systems

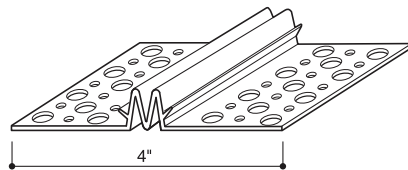

PRODUCT NUMBER	FINISH THICKNESS	INSULATION THICKNESS	DIMENSIONS	PIECES PER BOX
1538	3/8"	ALL	"V" slot, 4" overall width perforated flanges	35

EIFS PM Control Joint (3/8" Finish Systems) – Designed by Vinyl Corp.™ to relieve stress caused by expansion and contraction in large areas of walls and ceilings. Large perforations allow cement matrix to easily flow thru and anchor to substrate. Recommended usage is for every 130 to 140 sq. ft., with no one side being longer than 15 ft.

Caulk all intersections, butt joints, ends and corners at time of installation.

Drip Casing Bead

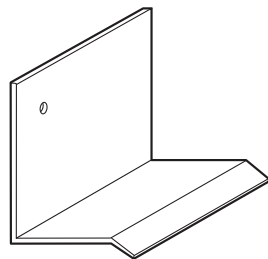
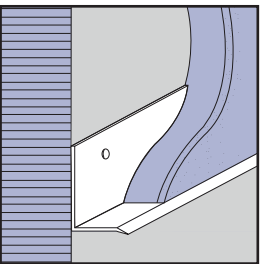

*Also available in "Arched" ask your ISR/OSR for more details.

PRODUCT NUMBER	FINISH THICKNESS	INSULATION THICKNESS	DIMENSIONS	PIECES PER BOX
DCB75-25	1/4"	3/4"	2" back flange (for splice use same size drip bead, cut to length, install under drip bead at butt joints)	50
DCB100-25	1/4"	1"		50
DCB150-25	1/4"	1-1/2"		50
DCB200-25	1/4"	2"		50

EIFS PM Drip Casing Beads – Designed by Vinyl Corp.™ as a base support starter strip with drip leg for exterior insulated wall systems. Drip leg moves moisture away from openings or foundation walls.

Caulk all intersections, butt joints, ends and corners at time of installation.

CONCRETE PANEL AND INSULATION QUICK-R

DCI – “V” Reveal

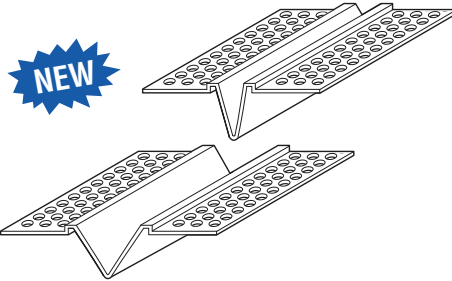
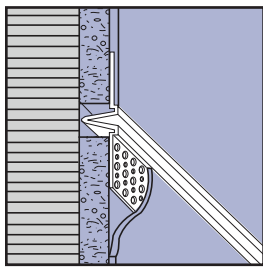

PRODUCT NUMBER	BOARD THICKNESS	DIMENSIONS	PIECES PER BOX
DCI-50-75	1/2" or 5/8"	3/4" reveal, 1-1/8" perforated flange	25

Vinyl Corp.™ New V Reveal – a new look to a Veneer or Drywall finish.

PB Corner Beads

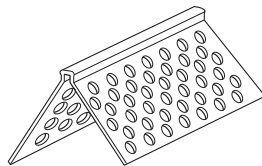
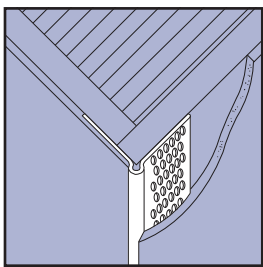

PRODUCT NUMBER	FINISH THICKNESS	INSULATION THICKNESS	DIMENSIONS	PIECES PER BOX
CB158E (8', 10')	1/16"	ALL	1-5/8" x 1-5/8" perforated flanges	75

Corner Beads – Designed by Vinyl Corp.™ with slightly wider flanges, but with all the features of the CB138E.

TIP: When joining continuous runs of corner bead, a preferred method of alignment is to miter the flanges. When creating Corner Bead Intersections, such as exterior soffit corners, miter all flanges to prevent overlapping, which will cause poor bonding and alignment.

PB Control Joint

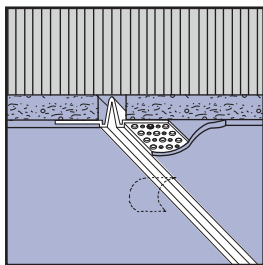

Surface Application with Removable Tape

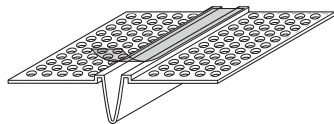

PRODUCT NUMBER	FINISH THICKNESS	INSULATION THICKNESS	DIMENSIONS	PIECES PER BOX
CJV-16E	1/16"	ALL	3/16" "V" Reveal, 1-1/8" perforated flanges	60

EIFS PB Control Joint (With Removable Tape) – Designed by Vinyl Corp.™ to relieve stress caused by expansion and contraction in large areas of walls and ceilings. Tape protects deep "V" expansion slot during construction. Large perforations allow matrix to easily flow thru and anchor to substrate. Recommended usage is for every 130-140 sq. ft. with no one side being longer than 15 ft.

Caulk all intersections, butt joints, ends and corners at time of installation.

DEFS Casing Beads

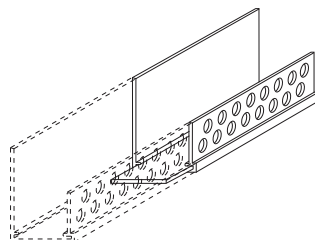
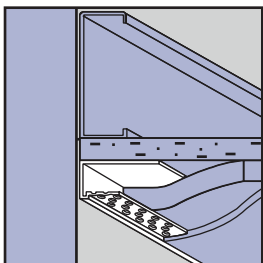

PRODUCT NUMBER	FINISH THICKNESS	INSULATION THICKNESS	DIMENSIONS	PIECES PER BOX
DE/CS50-16	1/16"	1/2"	1-3/4" back flange, 5/8" perforated flange	50
DE/CS58-16	1/16"	5/8"		50

DEFS Casing Beads – Designed by Vinyl Corp.™ to protect the raw edges of the new DEFS (Direct Applied) wall and ceiling systems. Two rows of large perforations allow matrix to easily flow thru and anchor to substrate. The Vinyl Corp.™ "Keylock"™ connectors are available for alignment and base for sealant. **U.S. Patent Numbers 5,946,870 and 6,119,429.**

Caulk all intersections, butt joints, ends and corners at time of installation.

CONCRETE PANEL AND INSULATION QUICK-R

DEFS Casing Beads (with Drip)

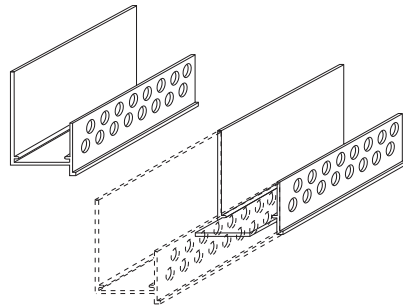
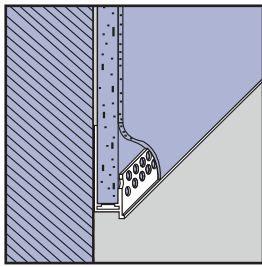

PRODUCT NUMBER	FINISH THICKNESS	INSULATION THICKNESS	DIMENSIONS	PIECES PER BOX
DE/CS50-16D	1/16"	1/2"	1-3/4" back flange, 5/8" perforated flange with drip	50
DE/CS58-16D	1/16"	5/8"		50

DEFS Casing Beads (With Drip) – Designed by Vinyl Corp.™ to protect the raw edges of the new DEFS (Direct Applied) wall and ceiling systems. Two rows of large perforations allow matrix to easily flow thru and anchor to substrate. Drip leg assists in moving moisture away from opening or foundation wall. The Vinyl Corp.™ “Keylock”™ connectors are available for alignment and base for sealant.

Caulk all intersections, butt joints, ends and corners at time of installation.

DEFS L Stop Casing Beads

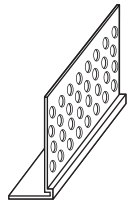
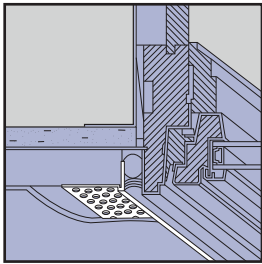

PRODUCT NUMBER	GROUND	DIMENSIONS	PIECES PER BOX
SBL50E	1/2"	1-3/4" perforated flange	50

L Stop Casing Bead – Provides casing against doors, windows and dissimilar materials. Perforated flange allows maximum adhesion of the matrix to the substrate.

Caulk all intersections, butt joints, ends and corners at time of installation.

3" Soffit Vents

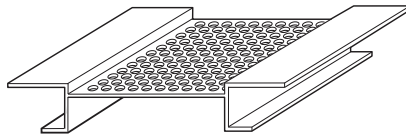
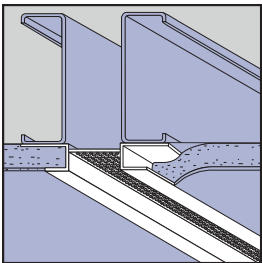

PRODUCT NUMBER	BOARD THICKNESS	DIMENSIONS	PIECES PER BOX
CSJ50-300V	1/2"	3" wide vent (one-piece), 5" overall width	18

3" Soffit Vents – Continuous one piece Soffit Vents. “J” Bead flanges cover raw edges of soffit board. Vent Clips are provided to connect Soffit Vent and assist in alignment.

Vent area: 15 square inches per lineal ft.

Caulk all intersections, butt joints, ends and corners at time of installation.

Miscellaneous 3" Soffit Vent

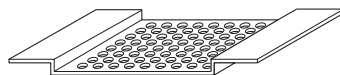
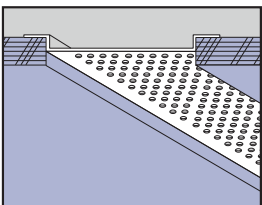

PRODUCT NUMBER	BOARD THICKNESS	DIMENSIONS	PIECES PER BOX
V-300	3/8"	3" wide vent (one piece), 4-3/8" overall width	40

3" Soffit Vents – One-piece Soffit Vent designed for soffit board, and may be combined with Starter Strip/Casing Beads or DEFS Casing Beads. Vent Clips are provided to connect Soffit Vent and assist in alignment.

Vent area: 15 square inches per lineal ft.

Caulk all intersections, butt joints, ends and corners at time of installation.

CONCRETE PANEL AND INSULATION QUICK-R

DEFS 45 Degree L Bead

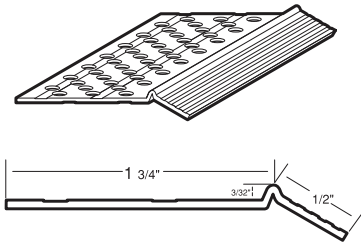
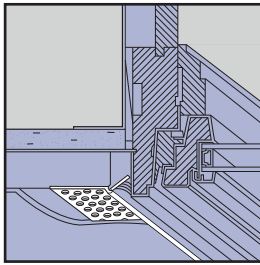

PRODUCT NUMBER

DIMENSIONS

PIECES PER BOX

DE/LB-45	perforated flange	50
45 Degree L Bead – Trim component used to finish around window and door penetrations as a backing for perimeter sealant application in DEFS installations. Caulk all intersections, butt joints, ends and corners at time of installation.		

PB Vented Reveals

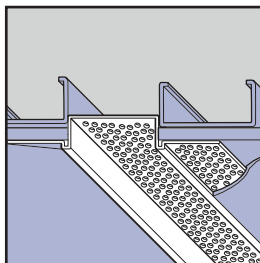

(Surface Mount — 1/16" to 3/32" Systems)

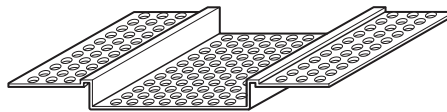

PRODUCT NUMBER

GROUND

DIMENSIONS

PIECES PER BOX

DCV50-150SE	1/2"	1-1/2" reveal	25
DCV50-200SE	1/2"	2" reveal	25
DCV50-300SE	1/2"	3" reveal	20
PB Vented Reveal – Creates a Vented reveal in exterior wall systems. Perforated flanges allow matrix to easily flow thru and adhere to substrate. Vent Area: 1-1/2" – 6 square inches per lineal ft.; 2" – 8 square inches per lineal ft.; 3" – 15 square inches per lineal ft. Caulk all intersections, butt joints, ends and corners at time of installation.			

PB Channel Reveals

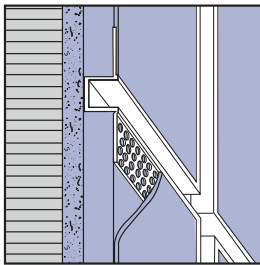

(Surface Mount – 1/16" to 3/32" Finish Systems)

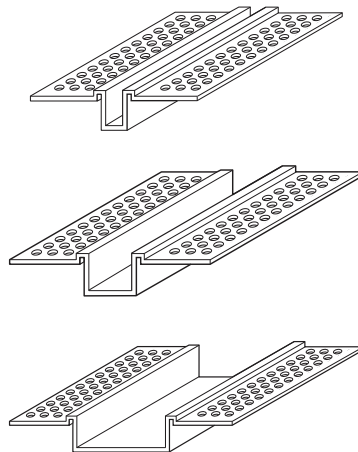

PRODUCT NUMBER

GROUND

DIMENSIONS

PIECES PER BOX

DC50-50SE	1/2"	1/2" reveal, perforated flanges	35
DC50-75SE	1/2"	3/4" reveal, perforated flanges	30
DC50-100SE	1/2"	1" reveal, perforated flanges	30
DC50-150SE	1/2"	1-1/2" reveal, perforated flanges	25
DC50-200SE	1/2"	2" reveal, perforated flanges	25
Channel Reveals (1/16" to 3/32" Finish Systems) – Creates reveals in exterior wall systems. Perforations allow matrix to easily flow thru and adhere to substrate. Factory-fabricated intersections are available to form clear channels. Caulk all intersections, butt joints, ends and corners at time of installation.			

Bold listing signifies new product offering.

PM Casing Beads

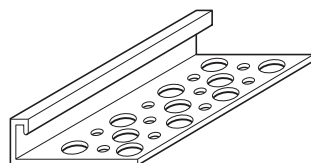
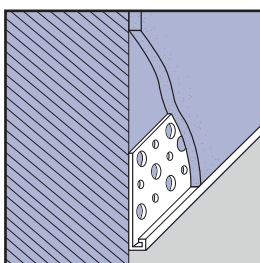

PRODUCT NUMBER

FINISH THICKNESS

INSULATION THICKNESS

DIMENSIONS

PIECES PER BOX

6625	1/4"	ALL	1-3/4" flange width, perforated flanges	100
PM Surface Casing Beads – Designed by Vinyl Corp.™ as a surface-mounted, direct applied base support Starter Strip or perimeter Casing Bead for 1/4" or 3/8" exterior insulated wall and ceiling systems. Perforated flange allows matrix to easily flow thru and anchor to substrate. <i>Note: 6638 also available with weep holes, order code 6638W. No return leg on 66187.</i>				

CONCRETE PANEL AND INSULATION QUICK-R

PM Control Joints

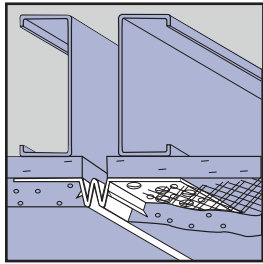

3/8" Finish Systems

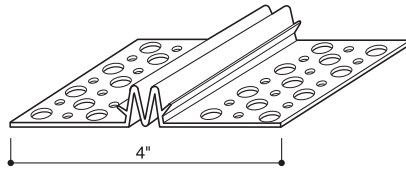

PRODUCT NUMBER	FINISH THICKNESS	INSULATION THICKNESS	DIMENSIONS	PIECES PER BOX
1538	3/8"	ALL	"V" slot, 4" overall width perforated flanges	35

EIFS PM Control Joint (3/8" Finish Systems) – Designed by Vinyl Corp.™ to relieve stress caused by expansion and contraction in large areas of walls and ceilings. Large perforations allow cement matrix to easily flow thru and anchor to substrate. Recommended usage is for every 130 to 140 sq. ft., with no one side being longer than 15 ft.

Caulk all intersections, butt joints, ends and corners at time of installation.

Drip Casing Bead

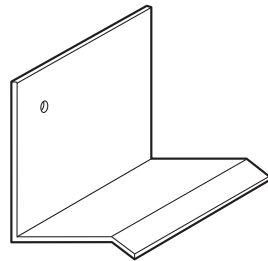
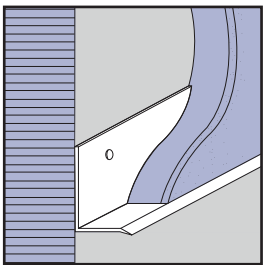

*Also available in "Arched" ask your ISR/OSR for more details.

PRODUCT NUMBER	FINISH THICKNESS	INSULATION THICKNESS	DIMENSIONS	PIECES PER BOX
DCB75-25	1/4"	3/4"	2" back flange (for splice use same size drip bead, cut to length, install under drip bead at butt joints)	50
DCB100-25	1/4"	1"		50
DCB150-25	1/4"	1-1/2"		50
DCB200-25	1/4"	2"		50

EIFS PM Drip Casing Beads – Designed by Vinyl Corp.™ as a base support starter strip with drip leg for exterior insulated wall systems. Drip leg moves moisture away from openings or foundation walls.

Caulk all intersections, butt joints, ends and corners at time of installation.

MAIN TRIMS

8034 - Ventilated Starter Strip

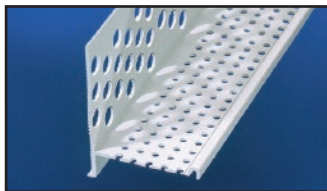

• Perforated Ø 6 mm and 2,54 mm

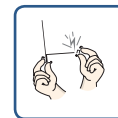
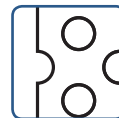
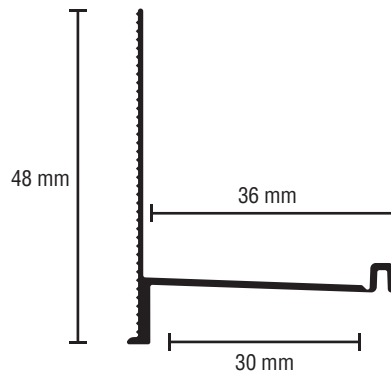

NOVA TRIM